



illuminating Design.....
THE LIGHTING DESTINATION



HPL Electric & Power Ltd

Corporate Office: Windsor Business Park, B-1D,
Sector-10, Noida, U.P. - 201301, INDIA.
Tel.: +91-120-4656300 | Fax: +91-120-4656333
Registered Office: 1/20, Asaf Ali Road, New Delhi - 110 002, INDIA.
E-mail: hpl@hplindia.com
Customer Care No. : 18004190198

Follow us:    

RTL/Cat/2019-20

RETAIL LIGHTING
Catalogue 2019



Corporate Profile

HPL is India's leading electric equipment manufacturer with a formidable presence across six key verticals: Metering Solutions, Switchgears, LED Lighting, Wire & Cables, Modular Switches & Solar.

Our backward integrated facilities have capabilities across product design and development, component designing, tool manufacturing and commercial production. An established brand with a proven track record of over four decades.

HPL enjoys strong recall across various customer segments. Through our innovative offerings, certified to conform to Indian and International standards such as ISI, CE and KEMA, we are proud to partner emerging India's electrical requirements.

HPL is well-placed to seize emerging opportunities

40+ Years of Industry Experience

7 State-of-art Manufacturing Facilities with **2** R&D Centers

19 Logistic centres in India & Union Territories

90+ Branch & Representative Offices

Strong Dealer & Distribution Network

Exporting to over **42** Countries

Key Strengths

Integrated Manufacturing Facilities

Located across North India in the states of Haryana and Himachal Pradesh. We have seven state-of-the-art manufacturing capabilities. These are equipped to manufacture customised products for institutional customers and undertake modifications in products for OEMs and other corporate customers as well as for the retail consumers. We manufacture all our products in-house, as well as several components used therein.

Certifications

HPL's manufacturing facilities are ISO:9001 certified for Quality Management System, ISO:14001 certified for Environmental System and OHSAS-18001 certified for implementing an occupational Health and Safety Management System. HPL products are also ISI Certified by the Bureau of Indian Standards, a mark of quality products in India.

Certain range of products have KEMA certification for energy utilization and have CE certificate to give acceptability of the products in Europe and other international markets. With these awards, accolades and certificates, HPL continues its journey towards a brighter and innovative future.



CONTENT

02 **Spot Lights**
• Dazzle • Dazzle C1/C2 • Luma
• Moni • Moni AD • Pendula

10 **Wall Washer**
• Extraar

12 **Track Lights**
• Extert - V • Extert - HLS
• Lumos • Bandor

20 **Downlights**
• Reflettore

22 **Trunking Light**
• Luxrectra

24 **Profile System**
• Linelight-R • Linelight-P

30 **Decorative Lights**
• Rays • Milan • Trios • Polo



Adapting to new working dynamics: Trends keep changing

We don't work in the same way we used to. Today many tasks are performed on the go or from remote locations. The mobile working and hot-desking trends are growing and people may work from different spots through the day. Task lighting, which allows people to turn lights on or off, is gaining traction, as it allows them to conserve energy. People can use the lights they need and turn off those they don't.

“Lighting plays a critical role in the retail sector, enabling stores to attract, engage and convert customers through innovative in-store lighting. It can help them create stories around their products, and transform stores into creative destinations offering an engaging experience to customers”.

Spot Lights

Fashion



Don't forget the dressing room When it comes to lighting

Accent lighting is needed to create a pleasant atmosphere. Our Spotlights with higher efficacy and better colour rendering index are very much effective for fashion store lighting.

Home Store

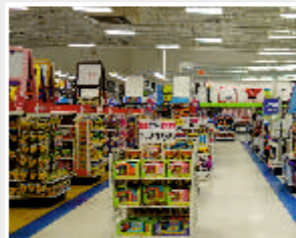

Creating brighter ideas

Home store needs energy efficient and good light distribution lighting systems. Our luminaires are designed with higher light output with better thermal dissipation.

Food

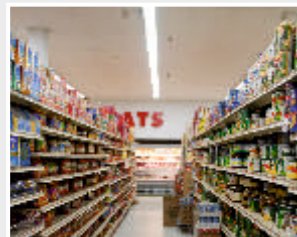

Freshest lights for Freshest foods.....

With our better CRI luminaires vividly colored fruits and vegetables can be appeared natural and fresh. And also using our higher efficacy luminaires energy can be saved.

Jewellery



Conveying authenticity!

Excellent colour rendering and special light spectrums improve perceived quality significantly. These latest-generation luminaires enshrine values such as credibility, originality and honesty.

Department Store



Improvising your STORE into a destination

Our better heat dissipation and higher efficacy lighting system can reduce lighting load without compromising in illuminance level.

Automotive



Upgrading your store to DRIVEN by lighting

Automotive showroom needs accent lighting with excellent color rendering. Detailed lighting system is needed for better visibility as well as natural appearances of car finishes and materials.





Dazzle

10W / 15W / 18W / 24W
30W / 36W / 45W

Product Description

- Best in class LED with high levels of efficiency and color rendering.
- Enclosure made of pressure die cast aluminium with powder coating finish.
- Optimized heat sink design gives better thermal management to ensure long lifetime.
- Professional optical design to ensure beam quality and outstanding effect. Constant color consistency and color homogeneity over the lifetime.
- Low maintenance costs due to low energy consumption and no re-lamping hassle.
- PC film for lesser transmission loss.
- Efficient electronics mounted in isolated driver tray with connectors.
- High quality spring based mounting system.

Product Specification

Product Type	Recess Mounted
Lighting Source	COB
Driver Type	Constant Current AC - DC
Input Voltage Range	180V - 270V
Power Factor	>0.95
THD	< 10%
Light Output	120lm/W - 150lm/W
Secondary Optics Used	Anodized Aluminium Reflector
Beam Angle	12°, 24°, 40°, 60°
Installation	Recess mounting with SS toggles

Applications

- Retail Spaces
- Ambient
- Cash Counter
- Trial Room
- Stair Cases
- Cafeteria
- Corridors
- Reception

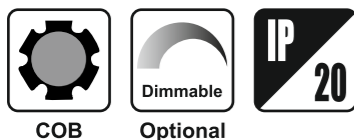
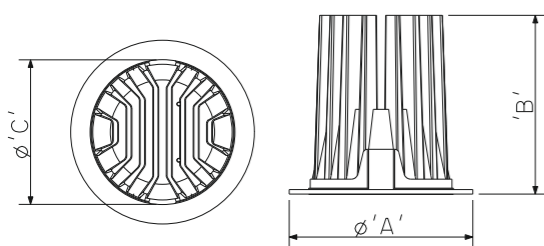

Product Details

Ordering Code	Watt	CCT	CRI	Dimension(mm)		(cutout) ØC
				ØA	B	
HPL.Dazzle.RE.01.10W.408.60D-W	10W	4000 K	80	123	115	110
HPL.Dazzle.RE.01.15W.408.60D-W	15W	4000 K	80	123	115	110
HPL.Dazzle.RE.01.18W.408.60D-W	18W	4000 K	80	123	115	110
HPL.Dazzle.RE.01.24W.408.60D-W	24W	4000 K	80	123	115	110
HPL.Dazzle.RE.01.30W.408.60D-W	30W	4000 K	80	123	115	110
HPL.Dazzle.RE.01.36W.408.60D-W	36W	4000 K	80	123	115	110
HPL.Dazzle.RE.01.45W.408.60D-W	45W	4000 K	80	123	115	110

408 (40 stands for 4000K CCT to be replaced by 30 or 50 for 3000K or 5000K CCT respectively). Other CCT available on request.
408 (8 stands for 80 CRI to be replaced by 7 or 9 for 70 or 90 CRI respectively).
Replace W (white) / B (Black) Add suffix DD-DALI Dimming, AD-Analog Dimming.
60 (60 stands for 60° beam angle to be replaced by 12, 24 or 40 for 12°, 24° or 40° respectively).



Dazzle C1

10W / 15W / 18W / 24W
30W / 36W / 45W

Product Description

- Recess mounted aimable down light luminaire with housing rotating through 350° and tilting through 20°.
- Enclosure made of pressure die cast aluminium with powder coating finish.
- Optimized heat sink design gives better thermal management to ensure long lifetime.
- Highly efficient aluminium anodized reflector in different beam angles.
- Professional optical design to ensure beam quality and outstanding effect. Constant color consistency and color homogeneity over the lifetime.
- PC film for lesser transmission loss.
- Efficient electronics mounted in isolated driver tray with connectors.
- High quality spring based mounting system.

Product Specification

Product Type	Recess Mounted
Lighting Source	COB
Driver Type	Constant Current AC - DC
Input Voltage Range	180V - 270V
Power Factor	>0.95
THD	< 10%
Light Output	120lm/W - 150lm/W
Secondary Optics Used	Anodized Aluminium Reflector
Beam Angle	12°, 24°, 40°, 60°
Installation	Recess mounting with SS toggles

Applications

- Peripheral Spaces
- Window Displays
- Wall Displays
- Retail Spaces
- Rack Light

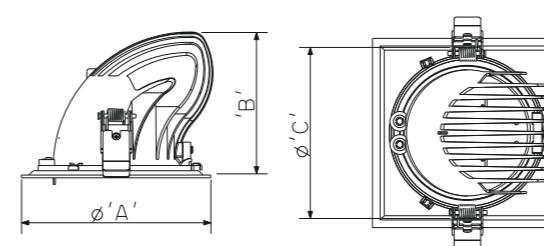

Product Details

Ordering Code	Watt	CCT	CRI	Dimension(mm)		(cutout) ØC
				ØA	B	
HPL.Dazzle-C1.RE.01.10W.408.60D-W	10W	4000 K	80	135X135	115	130
HPL.Dazzle-C1.RE.01.15W.408.60D-W	15W	4000 K	80	135X135	115	130
HPL.Dazzle-C1.RE.01.18W.408.60D-W	18W	4000 K	80	135X135	115	130
HPL.Dazzle-C1.RE.01.24W.408.60D-W	24W	4000 K	80	135X135	115	130
HPL.Dazzle-C1.RE.01.30W.408.60D-W	30W	4000 K	80	135X135	115	130
HPL.Dazzle-C1.RE.01.36W.408.60D-W	36W	4000 K	80	135X135	115	130

408 (40 stands for 4000K CCT to be replaced by 30 or 50 for 3000K or 5000K CCT respectively). Other CCT available on request.
408 (8 stands for 80 CRI to be replaced by 7 or 9 for 70 or 90 CRI respectively).
Replace W (white) / B (Black) Add suffix DD-DALI Dimming, AD-Analog Dimming.
60 (60 stands for 60° beam angle to be replaced by 12, 24 or 40 for 12°, 24° or 40° respectively).



Dazzle c2

10W / 15W / 18W / 24W
30W / 36W

Product Description

- Recess mounted aimable down light luminaire with housing rotating through 350° and tilting through 20°.
- Enclosure made of pressure die cast aluminium with powder coating finish.
- Optimized heat sink design gives better thermal management to ensure long lifetime.
- Highly efficient aluminium anodized reflector in different beam angles.
- Professional optical design to ensure beam quality and outstanding effect. Constant color consistency and color homogeneity over the lifetime.
- PC film for lesser transmission loss.
- Efficient electronics mounted in isolated driver tray with connectors.
- High quality spring based mounting system.

Product Specification

Product Type	Recess Mounted
Lighting Source	COB
Driver Type	Constant Current AC-DC
Input Voltage Range	180V - 270V
Power Factor	>0.95
THD	< 10%
Light Output	120lm/W - 150lm/W
Secondary Optics Used	Anodized Aluminium Reflector
Beam Angle	12°, 24°, 40°, 60°
Installation	Recess mounting with SS toggles

Applications

- Peripheral Spaces
- Retail Spaces
- Window Displays
- Rack Light
- Wall Displays

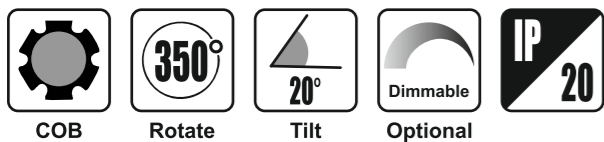
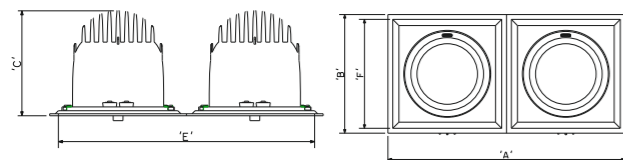

Product Details

Ordering Code	Watt	CCT	CRI	Dimension(mm)		
				A	B	(cutout) C
HPL.Dazzle-C2.RE.02.10W.408.60D-W	2x10W	4000K	80	160X325	115	152X317
HPL.Dazzle-C2.RE.02.15W.408.60D-W	2x15W	4000K	80	160X325	115	152X317
HPL.Dazzle-C2.RE.02.18W.408.60D-W	2x18W	4000K	80	160X325	115	152X317
HPL.Dazzle-C2.RE.02.24W.408.60D-W	2x24W	4000K	80	160X325	115	152X317
HPL.Dazzle-C2.RE.02.30W.408.60D-W	2x30W	4000K	80	160X325	115	152X317
HPL.Dazzle-C2.RE.02.36W.408.60D-W	2x36W	4000K	80	160X325	115	152X317

408 (40 stands for 4000K CCT to be replaced by 30 or 50 for 3000K or 5000K CCT respectively). Other CCT available on request.
408 (8 stands for 80 CRI to be replaced by 7 or 9 for 70 or 90 CRI respectively).
Replace W (white) / B (Black) Add suffix DD-DALI Dimming, AD-Analog Dimming.
60 (60 stands for 60° beam angle to be replaced by 12, 24 or 40 for 12°, 24° or 40° respectively).



Luma

10W / 15W / 18W / 24W
30W / 36W / 45W

Product Description

- Recess mounted aimable down light luminaire with housing tilting through 20°.
- Enclosure made of pressure die cast aluminium with powder coating finish.
- Optimized heat sink design gives better thermal management to ensure long lifetime.
- Highly efficient aluminium anodized reflector in different beam angles.
- Professional optical design to ensure beam quality and outstanding effect. Constant color consistency and color homogeneity over the lifetime.
- PC film for lesser transmission loss.
- Efficient electronics mounted in isolated driver tray with connectors.
- High quality spring based mounting system.

Product Specification

Product Type	Recess Mounted
Lighting Source	COB
Driver Type	Constant Current AC - DC
Input Voltage Range	180V - 270V
Power Factor	>0.95
THD	< 10%
Light Output	120 lm/watt - 150 lm/W
Secondary Optics Used	Anodized Aluminium Reflector
Beam Angle	12°, 24°, 40°, 60°
Installation	Recess mounting with SS toggles

Applications

- Peripheral Spaces
- Retail Spaces
- Wall Display Rack
- Window Displays
- Cash Counter
- Reception
- Wall Displays
- Trial Room

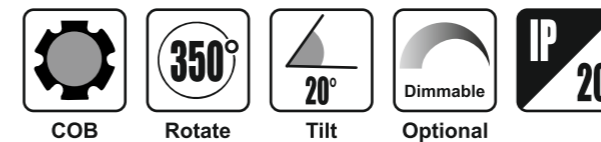
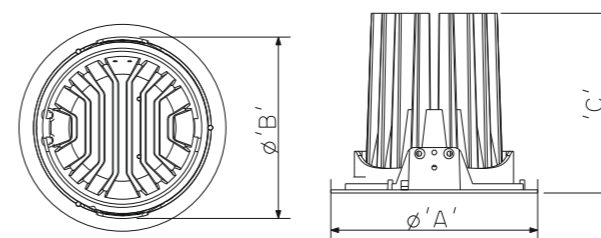

Product Details

Ordering Code	Watt	CCT	CRI	Dimension(mm)		
				ØA	B	(cutout) ØC
HPL.Luma.RE.01.10W.408.60D-W	10W	4000 K	80	135	115	130
HPL.Luma.RE.01.15W.408.60D-W	15W	4000 K	80	135	115	130
HPL.Luma.RE.01.18W.408.60D-W	18W	4000 K	80	135	115	130
HPL.Luma.RE.01.24W.408.60D-W	24W	4000 K	80	135	115	130
HPL.Luma.RE.01.30W.408.60D-W	30W	4000 K	80	135	115	130
HPL.Luma.RE.01.36W.408.60D-W	36W	4000 K	80	135	115	130
HPL.Luma.RE.01.45W.408.60D-W	45W	4000 K	80	135	115	130

408 (40 stands for 4000K CCT to be replaced by 30 or 50 for 3000K or 5000K CCT respectively). Other CCT available on request.
408 (8 stands for 80 CRI to be replaced by 7 or 9 for 70 or 90 CRI respectively).
Replace W (white) / B (Black) Add suffix DD-DALI Dimming, AD-Analog Dimming.
60 (60 stands for 60° beam angle to be replaced by 12, 24 or 40 for 12°, 24° or 40° respectively).



Moni

18W

Product Description

- Surface mounted down light luminaire.
- Best in class LED with high levels of efficiency and colour rendering.
- Enclosure made of pressure die casting with aluminium powder coated finish and heat sink for better heat dissipation.
- Optimized heat sink design gives better thermal management to ensure long lifetime.
- Professional optical design to ensure beam quality and outstanding effect. Constant color consistency and color homogeneity over the lifetime.
- Low maintenance costs due to low energy consumption and no re-lamping hassle.
- PC film for lesser transmission loss.
- Inbuilt efficient electronic mounted in isolated driver compartment with connectors.

Product Specification

Product Type	Surface Mounted
Lighting Source	COB
Driver Type	Constant Current AC - DC
Input Voltage Range	180V - 270V
Power Factor	>0.95
THD	< 10%
Light Output	80 lm/W - 100 lm/W
Secondary Optics Used	Anodized Aluminium Reflector
Beam Angle	12°, 24°, 40°, 60°
Installation	Surface Mounted

Applications

- Cafeteria
- Reception
- Window Displays

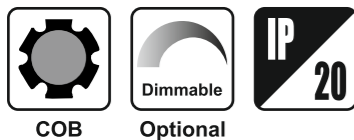

Product Details

Ordering Code	Watt	CCT	CRI	Dimension(mm)	
				ØA	B
HPLEDDWL2030CG	18W	4000 K	80	100	150

408 (40 stands for 4000K CCT to be replaced by 30 or 50 for 3000K or 5000K CCT respectively). Other CCT available on request.
 408 (8 stands for 80 CRI to be replaced by 7 or 9 for 70 or 90 CRI respectively).
 Replace W (white) / B (Black) Add suffix DD-DALI Dimming, AD-Analog Dimming.
 60 (60 stands for 60° beam angle to be replaced by 12, 24 or 40 for 12°, 24° or 40° respectively).
 RE (RE stands for products type).



Moni AD

18W

Product Description

- Surface mounted down light luminaire.
- Best in class LED with high levels of efficiency and colour rendering.
- Enclosure made of pressure die casting with aluminium powder coated finish and heat sink for better heat dissipation.
- Optimized heat sink design gives better thermal management to ensure long lifetime.
- Professional optical design to ensure beam quality and outstanding effect. Constant color consistency and color homogeneity over the lifetime.
- Low maintenance costs due to low energy consumption and no re-lamping hassle.
- PC film for lesser transmission loss.
- Inbuilt efficient electronic mounted in isolated driver compartment with connectors.

Product Specification

Product Type	Surface Mounted
Lighting Source	COB
Driver Type	Constant Current AC - DC
Input Voltage Range	180V - 270V
Power Factor	>0.95
THD	< 10%
Light Output	80 lm/W - 100 lm/W
Secondary Optics Used	Anodized Aluminium Reflector
Beam Angle	12°, 24°, 40°, 60°
Installation	Surface Mounted

Applications

- Cafeteria
- Reception
- Window Displays

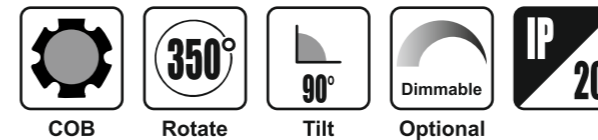

Product Details

Ordering Code	Watt	CCT	CRI	Dimension(mm)	
				ØA	B
HPLEDWL1830	18W	4000 K	80	100	150

408 (40 stands for 4000K CCT to be replaced by 30 or 50 for 3000K or 5000K CCT respectively). Other CCT available on request.
 408 (8 stands for 80 CRI to be replaced by 7 or 9 for 70 or 90 CRI respectively).
 Replace W (white) / B (Black) Add suffix DD-DALI Dimming, AD-Analog Dimming.
 60 (60 stands for 60° beam angle to be replaced by 12, 24 or 40 for 12°, 24° or 40° respectively).
 RE (RE stands for products type).



Pendula

10W / 15W / 18W / 24W / 30W

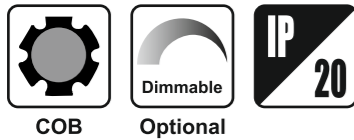
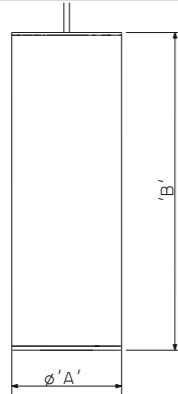

Product Description

- Pendant mounted down light luminaire
- Best in class LED with high levels of efficiency and colour rendering.
- Enclosure made of extruded aluminium with powder coating finish and extruded heat sink for better heat dissipation.
- Optimized heat sink design gives better thermal management to ensure long lifetime.
- Professional optical design to ensure beam quality and outstanding effect. Constant color consistency and color homogeneity over the lifetime.
- PC film for lesser transmission loss.
- Inbuilt efficient electronic mounted in isolated driver compartment with connectors
- High quality suspension kit for mounting.

Product Specification

Product Type	Pendant Mounted
Lighting Source	COB
Driver Type	Constant Current AC - DC
Input Voltage Range	180V - 270V
Power Factor	>0.95
THD	< 10%
Light Output	120 lm/W - 150 lm/W
Secondary Optics Used	Anodized Aluminium Reflector
Beam Angle	12°, 24°, 40°, 60°
Installation	High quality suspension kit for mounting

Applications

- Cash Counter
- Cafeteria
- Reception
- Window Displays

Product Details

Ordering Code	Watt	CCT	CRI	Dimension(mm)	
				ØA	B
HPL.Pendula.PE.01.10W.408.60D-W	10W	4000 K	80	80	220
HPL.Pendula.PE.01.15W.408.60D-W	15W	4000 K	80	80	220
HPL.Pendula.PE.01.18W.408.60D-W	18W	4000 K	80	80	220
HPL.Pendula.PE.01.24W.408.60D-W	24W	4000 K	80	80	220
HPL.Pendula.PE.01.30W.408.60D-W	30W	4000 K	80	80	220
HPL.Pendula.PE.01.30W.408.60D-W	30W	4000 K	80	95	220
HPL.Pendula.PE.01.36W.408.60D-W	36W	4000 K	80	95	220

408 (40 stands for 4000K CCT to be replaced by 30 or 50 for 3000K or 5000K CCT respectively). Other CCT available on request.

408 (8 stands for 80 CRI to be replaced by 7 or 9 for 70 or 90 CRI respectively).

Replace W (white) / B (Black) Add suffix DD-DALI Dimming, AD-Analog Dimming.

60 (60 stands for 60° beam angle to be replaced by 12, 24 or 40 for 12°, 24° or 40° respectively).

Wall Washer





Extraar

10W / 15W / 18W / 24W
30W / 36W

Product Description

- Recess mounted aimable down light luminaire with housing rotating through 350° and tilting through 60°.
- Enclosure made of pressure die cast aluminium with powder coating finish.
- Optimized heat sink design gives better thermal management to ensure long lifetime.
- Professional optical design to ensure beam quality and outstanding effect. Constant color consistency and color homogeneity over the lifetime.
- Low maintenance costs due to low energy consumption and no re-lamping hassle.
- PC film for lesser transmission loss.
- Efficient electronics mounted in isolated driver tray with connectors.
- High quality spring based mounting system.

Product Specification

Product Type	Recess Mounted
Lighting Source	COB
Driver Type	Constant Current AC - DC
Input Voltage Range	180V - 270V
Power Factor	>0.95
THD	< 10%
Light Output	120 lm/W - 150 lm/W
Secondary Optics Used	Anodized Aluminium Reflector
Beam Angle	12°, 24°, 40°, 60°
Installation	Recess mounting with SS toggles

Applications

- Peripheral Spaces
- Retail Spaces
- Wall Display Rack
- Window Displays
- Cash Counter
- Reception
- Wall Displays
- Trial Room

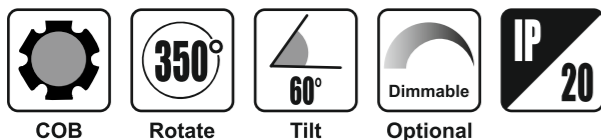
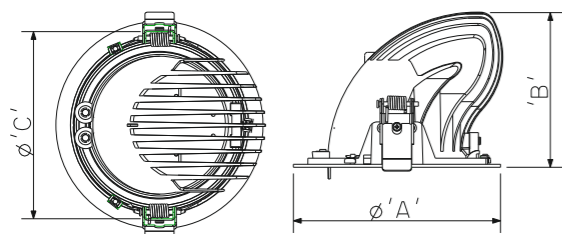

Product Details

Ordering Code	Watt	CCT	CRI	Dimension(mm)		(cutout) øC
				øA	B	
HPL.Extraar.RE.01.0110W.408.60D-W	10W	4000 K	80	135	115	130
HPL.Extraar.RE.01.15W.408.60D-W	15W	4000 K	80	135	115	130
HPL.Extraar.RE.01.18W.408.60D-W	18W	4000 K	80	135	115	130
HPL.Extraar.RE.01.24W.408.60D-W	24W	4000 K	80	135	115	130
HPL.Extraar.RE.01.30W.408.60D-W	30W	4000 K	80	135	115	130
HPL.Extraar.RE.01.36W.408.60D-W	36W	4000 K	80	135	115	130
HPL.Extraar.RE.01.45W.408.60D-W	45W	4000 K	80	155	125	150

408 (40 stands for 4000K CCT to be replaced by 30 or 50 for 3000K or 5000K CCT respectively). Other CCT available on request.

408 (8 stands for 80 CRI to be replaced by 7 or 9 for 70 or 90 CRI respectively).

Replace W (white) / B (Black) Add suffix DD-Dimmable Dali, AD-Analog Dali.

60 (60 stands for 60° beam angle to be replaced by 12, 24 or 40 for 12°, 24° or 40° respectively).



Track Lights



Extert - V

10W / 15W / 18W / 24W
30W / 36W

Product Description

- Track mounted aimable down light luminaire in vertical orientation with led housing rotating through 350° and tilting through 180°.
- Enclosure made of pressure die cast with powder coating finish which acts as passive heat sink.
- Optimized heat sink design gives better thermal management to ensure long lifetime.
- Professional optical design to ensure beam quality and outstanding effect. Constant color consistency and color homogeneity over the lifetime.
- PC film for lesser transmission loss.
- Efficient electronics mounted in isolated driver compartment with connectors.
- Power track adapter (2 Wire/4 Wire) provided to the fixture on power track.

Product Specification

Product Type	Track Mounted
Lighting Source	COB
Driver Type	Constant Current AC - DC
Input Voltage Range	180V - 270V
Power Factor	>0.95
THD	< 10%
Light Output	120lm/W - 150lm/W
Secondary Optics Used	Anodized Aluminium Reflector
Beam Angle	12°, 24°, 40°, 60°
Installation	Power track adapter (2/4 Wire) provided to fix the fixture on power tracks

Applications

- Peripheral Spaces
- Retail Spaces
- Wall Graphics
- Window Displays
- Wall Niche
- Display Racks
- Wall Displays
- Wall Racks
- Cafeteria

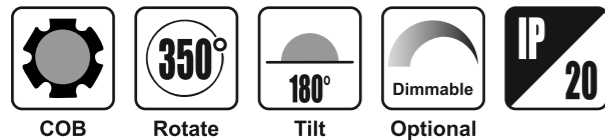
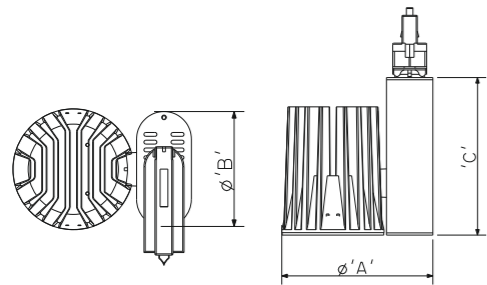

Product Details

Ordering Code	Watt	CCT	CRI	Dimension(mm)		
				A	B	C
HPL.Extert-V.TK.01.10W.408.60D-W	10W	4000 K	80	160	90	125
HPL.Extert-V.TK.01.15W.408.60D-W	15W	4000 K	80	160	90	125
HPL.Extert-V.TK.01.18W.408.60D-W	18W	4000 K	80	160	90	125
HPL.Extert-V.TK.01.24W.408.60D-W	24W	4000 K	80	160	90	125
HPL.Extert-V.TK.01.30W.408.60D-W	30W	4000 K	80	160	90	125
HPL.Extert-V.TK.01.36W.408.60D-W	36W	4000 K	80	160	90	125

408 (40 stands for 4000K CCT to be replaced by 30 or 50 for 3000K or 5000K CCT respectively). Other CCT available on request.
408 (8 stands for 80 CRI to be replaced by 7 or 9 for 70 or 90 CRI respectively).
Replace W(white) / B (Black) Add suffix DD-DALI Dimming, AD-Analog Dimming.
60 (60 stands for 60° beam angle to be replaced by 12, 24 or 40 for 12°, 24° or 40° respectively).



Extert - HLS

30W

Product Description

- Track mounted aimable down light luminaire in vertical orientation with led housing rotating through 350° and tilting through 90°.
- Enclosure made of pressure die cast with powder coating finish which acts as passive heat sink.
- Optimized heat sink design gives better thermal management to ensure long lifetime.
- Professional optical design to ensure beam quality and outstanding effect. Constant color consistency and color homogeneity over the lifetime.
- PC film for lesser transmission loss.
- Efficient electronics mounted in isolated driver compartment with connectors.
- Power track adapter (2 Wire/4 Wire) provided to the fixture on power track.

Product Specification

Product Type	Track Mounted
Lighting Source	COB
Driver Type	Constant Current AC - DC
Input Voltage Range	180V - 270V
Power Factor	>0.95
THD	< 10%
Light Output	120lm/W - 150lm/W
Secondary Optics Used	Anodized Aluminium Reflector
Beam Angle	12°, 24°, 40°, 60°
Installation	Power track adapter (2/4 Wire) provided to fix the fixture on power tracks

Applications

- Peripheral Spaces
- Retail Spaces
- Wall Graphics
- Window Displays
- Wall Niche
- Display Racks
- Wall Displays
- Wall Racks
- Cafeteria

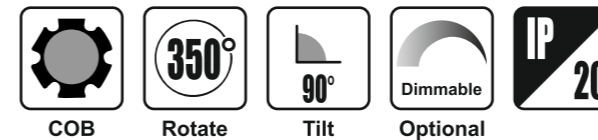

Product Details

Ordering Code	Watt	CCT	CRI	Dimension(mm)		
				A	B	C
HLPTRACK30W(OV)BL	12W	4000 K	80	60	160	100

408 (40 stands for 4000K CCT to be replaced by 30 or 50 for 3000K or 5000K CCT respectively). Other CCT available on request.
408 (8 stands for 80 CRI to be replaced by 7 or 9 for 70 or 90 CRI respectively).
Replace W (white) / B (Black) Add suffix DD-DALI Dimming, AD-Analog Dimming.
60 (60 stands for 60° beam angle to be replaced by 12, 24 or 40 for 12°, 24° or 40° respectively).
RE (RE stands for products type).



Lumos

30W / 36W

Product Description

- Track mounted aimable down light luminaire in vertical orientation with led housing rotating through 350° and tilting through 90°.
- Enclosure made of extruded aluminium with powder coating finish and extruded heat sink for better heat dissipation.
- Optimized heat sink design gives better thermal management to ensure long lifetime.
- Professional optical design to ensure beam quality and outstanding effect. Constant color consistency and color homogeneity over the lifetime.
- PC film for lesser transmission loss.
- Efficient electronics mounted in isolated driver compartment with connectors.
- Power track adapter (2 Wire/ 4 Wire) provided to the fixture on power track.

Product Specification

Product Type	Track Mounted
Lighting Source	COB
Driver Type	Constant Current AC - DC
Input Voltage Range	180V - 270V
Power Factor	>0.95
THD	< 10%
Light Output	120lm/W - 150lm/W
Secondary Optics Used	Anodized Aluminium Reflector
Beam Angle	12°, 24°, 40°, 60°
Installation	Power track adapter (2/4 Wire) provided to fix the fixture on power tracks

Applications

- Retail Spaces
- Ambient
- Cash Counter
- Trail Room
- Stair Cases
- Cafeteria
- Corridors
- Reception

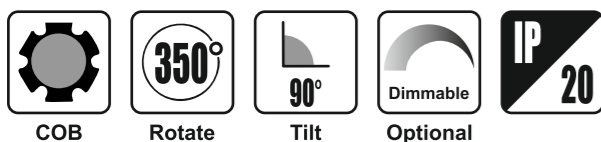
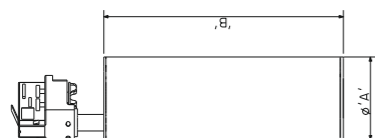

Product Details

Ordering Code	Watt	CCT	CRI	Dimension(mm)	
				ØA	B
HPL.Lumos.TK.01.30W.408.60D-W	30W	4000 K	80	95	220
HPL.Lumos.TK.01.36W.408.60D-W	36W	4000 K	80	95	220

408 (40 stands for 4000K CCT to be replaced by 30 or 50 for 3000K or 5000K CCT respectively). Other CCT available on request.
 408 (8 stands for 80 CRI to be replaced by 7 or 9 for 70 or 90 CRI respectively).
 Replace W (white) / B (Black) Add suffix DD-Dimmable Dali, AD-Analog Dali.
 60 (60 stands for 60° beam angle to be replaced by 12, 24 or 40 for 12°, 24° or 40° respectively).



Lumos

10W / 15W / 18W / 24W / 30W

Product Description

- Track mounted aimable down light luminaire in vertical orientation with led housing rotating through 350° and tilting through 90°.
- Enclosure made of extruded aluminium with powder coating finish and extruded heat sink for better heat dissipation.
- Optimized heat sink design gives better thermal management to ensure long lifetime.
- Professional optical design to ensure beam quality and outstanding effect. Constant color consistency and color homogeneity over the lifetime.
- PC film for lesser transmission loss.
- Efficient electronics mounted in isolated driver compartment with connectors.
- Power track adapter (2 Wire/ 4 Wire) provided to the fixture on power track.

Product Specification

Product Type	Track Mounted
Lighting Source	COB
Driver Type	Constant Current AC-DC
Input Voltage Range	180V - 270V
Power Factor	>0.95
THD	< 10%
Light Output	120lm/W - 150lm/W
Secondary Optics Used	Anodized Aluminium Reflector
Beam Angle	12°, 24°, 40°, 60°
Installation	Power track adapter (2/4 Wire) provided to fix the fixture on power tracks

Applications

- Retail Spaces
- Ambient
- Cash Counter
- Trail Room
- Stair Cases
- Cafeteria
- Corridors
- Reception

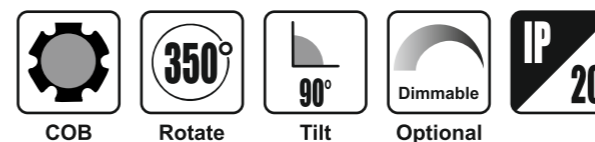
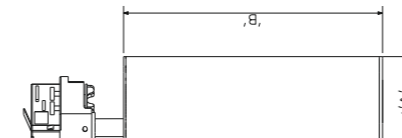

Product Details

Ordering Code	Watt	CCT	CRI	Dimension(mm)	
				ØA	B
HPL.Lumos.TK.01.10W.408.60D-W	10W	4000 K	80	80	220
HPL.Lumos.TK.01.15W.408.60D-W	15W	4000 K	80	80	220
HPL.Lumos.TK.01.18W.408.60D-W	18W	4000 K	80	80	220
HPL.Lumos.TK.01.24W.408.60D-W	24W	4000 K	80	80	220
HPL.Lumos.TK.01.30W.408.60D-W	30W	4000 K	80	80	220

408 (40 stands for 4000K CCT to be replaced by 30 or 50 for 3000K or 5000K CCT respectively). Other CCT available on request.
 408 (8 stands for 80 CRI to be replaced by 7 or 9 for 70 or 90 CRI respectively).
 Replace W (white) / B (Black) Add suffix DD-Dimmable Dali, AD-Analog Dali.
 60 (60 stands for 60° beam angle to be replaced by 12, 24 or 40 for 12°, 24° or 40° respectively).



Bandor

10W / 15W / 18W / 24W
30W / 36W

Product Description

- Track mounted aimable down light luminaire in vertical orientation with led housing rotating through 350° and tilting through 90°.
- Enclosure made of extruded aluminium with powder coating finish and extruded heat sink for better heat dissipation.
- Optimized heat sink design gives better thermal management to ensure long lifetime.
- Professional optical design to ensure beam quality and outstanding effect. Constant color consistency and color homogeneity over the lifetime.
- PC film for lesser transmission loss.
- Efficient electronics mounted in isolated driver compartment with connectors.
- Power track adapter (2 Wire/ 4 Wire) provided to the fixture on power track.

Product Specification

Product Type	Track Mounted
Lighting Source	COB
Driver Type	Constant Current AC - DC
Input Voltage Range	180V - 270V
Power Factor	>0.95
THD	< 10%
Light Output	120lm/W - 150lm/W
Secondary Optics Used	Anodized Aluminium Reflector
Beam Angle	12°, 24°, 40°, 60°
Installation	Power track adapter (2/4 Wire) provided to fix the fixture on power tracks

Applications

- Peripheral Spaces
- Retail Spaces
- Wall Graphics
- Window Displays
- Wall Niche
- Display Racks
- Wall Displays
- Wall Racks
- Cafeteria

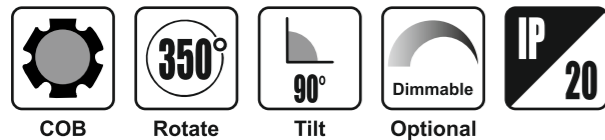
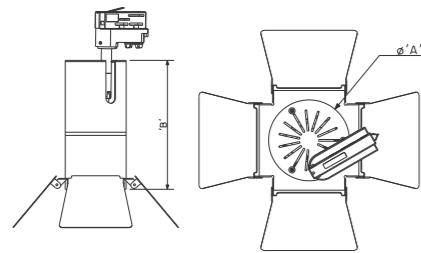

Product Details

Ordering Code	Watt	CCT	CRI	Dimension(mm)	
				ØA	B
HPL.Bandor.TK.0110W.408.60D-W	10W	4000 K	80	90	220
HPL.Bandor.TK.0115W.408.60D-W	15W	4000 K	80	90	220
HPL.Bandor.TK.0118W.408.60D-W	18W	4000 K	80	90	220
HPL.Bandor.TK.0124W.408.60D-W	24W	4000 K	80	90	220
HPL.Bandor.TK.0130W.408.60D-W	30W	4000 K	80	90	220
HPL.Bandor.TK.0136W.408.60D-W	36W	4000 K	80	90	220

408 (40 stands for 4000K CCT to be replaced by 30 or 50 for 3000K or 5000K CCT respectively). Other CCT available on request.
 408 (8 stands for 80 CRI to be replaced by 7 or 9 for 70 or 90 CRI respectively).
 Replace W (white) / B (Black) Add suffix DD-DALI Dimming, AD-Analog Dimming.
 60 (60 stands for 60° beam angle to be replaced by 12, 24 or 40 for 12°, 24° or 40° respectively).





Extertdiva

10W / 15W / 18W / 24W / 30W



Product Description

- Track mounted aimable down light luminaire in vertical orientation with led housing rotating through 350° and tilting through 180°.
- Enclosure made of extruded aluminium with powder coating finish and extruded heat sink for better heat dissipation.
- Optimized heat sink design gives better thermal management to ensure long lifetime.
- Professional optical design to ensure beam quality and outstanding effect. Constant color consistency and color homogeneity over the lifetime.
- PC film for lesser transmission loss.
- Efficient electronics mounted in isolated driver compartment with connectors.
- Power track adapter (2 Wire/ 4 Wire) provided to the fixture on power track.

Product Specification

Product Type	Track Mounted
Lighting Source	COB
Driver Type	Constant Current AC - DC
Input Voltage Range	180V - 270V
Power Factor	>0.95
THD	< 10%
Light Output	120lm/W - 150lm/W
Secondary Optics Used	Anodized Aluminium Reflector
Beam Angle	12°, 24°, 40°, 60°
Installation	Power track adapter (2/4 Wire) provided to fix the fixture on power tracks

Applications

- Retail Spaces
- Ambient
- Cash Counter
- Trail Room
- Stair Cases
- Cafeteria
- Corridors
- Reception

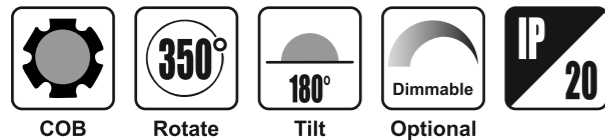
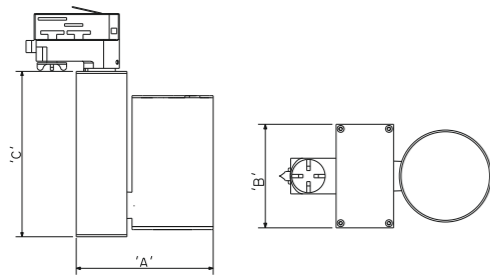

Product Details

Ordering Code	Watt	CCT	CRI	Dimension(mm)		
				A	B	C
HPL.Extertdiva.TK.01.10W.408.60D-W	10W	4000 K	80	160	90	125
HPL.Extertdiva.TK.01.15W.408.60D-W	15W	4000 K	80	160	90	125
HPL.Extertdiva.TK.01.18W.408.60D-W	18W	4000 K	80	160	90	125
HPL.Extertdiva.TK.01.24W.408.60D-W	24W	4000 K	80	160	90	125
HPL.Extertdiva.TK.01.30W.408.60D-W	30W	4000 K	80	160	90	125

408 (40 stands for 4000K CCT to be replaced by 30 or 50 for 3000K or 5000K CCT respectively). Other CCT available on request.
 408 (8 stands for 80 CRI to be replaced by 7 or 9 for 70 or 90 CRI respectively).
 Replace W (white) / B (Black) Add suffix DD-DALI Dimming, AD-Analog Dimming.
 60 (60 stands for 60° beam angle to be replaced by 12, 24 or 40 for 12°, 24° or 40° respectively).



Downlights



Reflettore

10W / 15W / 18W / 24W



Product Description

- Recess mounted down light luminaire.
- Best in class LED with high levels of efficiency and colour rendering.
- Enclosure made of pressure die cast with powder coating finish which acts as passive heat sink.
- High efficient moulded PC diffuser for lesser transmission loss.
- Low maintenance costs due to low energy consumption and no re-lamping hassle.
- Efficient electronics mounted in isolated driver tray with connectors.
- High quality spring based mounting system.

Product Specification

Product Type	Recess Mounted
Lighting Source	SMD
Driver Type	Constant Current AC - DC
Input Voltage Range	180V - 270V
Power Factor	>0.95
THD	< 10%
Secondary Optics Used	High Efficiency Diffuser
Beam Angle	Diffused
Installation	Recess mounting with SS toggles

Applications

- Retail Spaces
- Cafeteria
- Hospitals
- Ambient
- Corridors
- Kitchen
- Stair Cases
- Office Space
- Conference Rooms
- Wash Rooms
- Back Offices

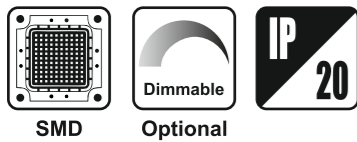
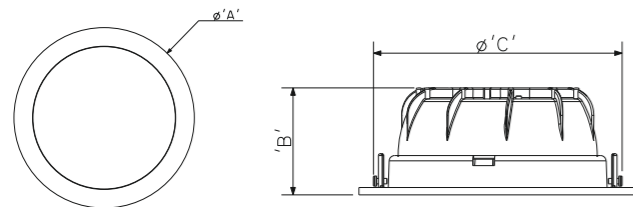

Product Details

Ordering Code	Watt	CCT	CRI	Dimension(mm)		
				ØA	B	(cutout) ØC
HPL.Reflettore.RE.01.10W.408.60D-W	10W	4000 K	80	155	70	138
HPL.Reflettore.RE.01.15W.408.60D-W	15W	4000 K	80	155	70	138
HPL.Reflettore.RE.01.18W.408.60D-W	18W	4000 K	80	155	70	138
HPL.Reflettore.RE.01.24W.408.60D-W	24W	4000 K	80	155	70	138

408 (40 stands for 4000K CCT to be replaced by 30 or 50 for 3000K or 5000K CCT respectively). Other CCT available on request.

408 (8 stands for 80 CRI to be replaced by 7 or 9 for 70 or 90 CRI respectively).

Replace W (white) / B (Black) Add suffix DD-DALI Dimming, AD-Analog Dimming.

60 (60 stands for 60° beam angle to be replaced by 12, 24 or 40 for 12°, 24° or 40° respectively).



Trunking Light





Luxrecta

28W / 36W / 40W



Product Description

- LED modular system for trunking installation, including LED luminaires, aluminum installation profile and diffusers.
- Drivers included in lighting modules for AC 220-240V / 50Hz connection to mains or to other lighting modules.
- Suspension kit is included. The LED linear trunking lights are simple mounting.
- All system components, trunking rail and luminaire inserts are perfectly matched according to dimensions.
- Triple, double and single-length rails can be combined to comply with the space involved.
- Modules can be positioned in the rails with randomly defined distances according to system dimensions for both trunking rail and individual luminaire installations, meaning that mounting and installation is highly rapid.

Product Specification

Product Type	Trunking Mounted Linear Down Light is a LED Lighting solution.
Lighting Source	SMD
Driver Type	Constant Current AC - DC
Input Voltage Range	180V - 270V
Power Factor	>0.95
THD	< 10%
Light Output	110lm/W - 160lm/W
Secondary Optics Used	High Efficiency Diffuser
Beam Angle	Diffused
Installation	High quality suspension kit for mounting.

Applications

- Retail Spaces
- General Areas
- Rack Light

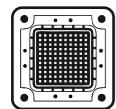
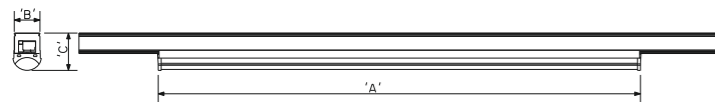

SMD



Dimmable
Optional



IP 20

Product Details

Ordering Code	Watt	CCT	CRI	Dimension(mm)		
				A	B	C
HPL.Luxrecta.TR.01.28W.408.D-W	28W	4000 K	80	1130	85	60
HPL.Luxrecta.TR.01.36W.408.D-W	36W	4000 K	80	1130	85	60
HPL.Luxrecta.TR.01.40W.408.D-W	40W	4000 K	80	1130	85	60

408 (40 stands for 4000K CCT to be replaced by 30 or 50 for 3000K or 5000K CCT respectively). Other CCT available on request.

408 (8 stands for 80 CRI to be replaced by 7 or 9 for 70 or 90 CRI respectively).

Replace W (white) / B (Black) Add suffix DD-DALI Dimming, AD-Analog Dimming.

60 (60 stands for 60° beam angle to be replaced by 12, 24 or 40 for 12°, 24° or 40° respectively).

Profile System





Linelight-R

14W / 28W / 36W / 40W
56W / 72W / 80W

Product Description

- Recess mounted linear down light luminaire.
- Best in class LED with high levels of efficiency and colour rendering.
- Enclosure made of heavy gauge extruded aluminium housing with powder coating finish which acts as passive heat sink.
- Extruded diffuser for higher light transmission.
- Inbuilt efficient electronics driver & electronic accessories with connectors.
- Special mounting brackets provided.

Product Specification

Product Type	Recess Mounted
Lighting Source	SMD
Driver Type	Constant Current AC-DC
Input Voltage Range	180V - 270V
Power Factor	>0.95
THD	< 10%
Light Output	110lm/W-160lm/W
Secondary Optics Used	High Efficiency Diffuser
Beam Angle	Diffused
Installation	Special mounting brackets provided.

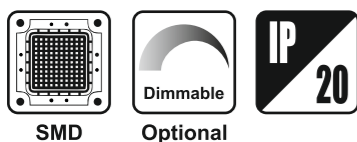
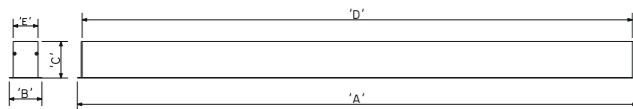

Applications

- Retail Spaces
- Ambient
- Cash Counter
- Trail Room
- Stair Cases
- Cafeteria
- Corridors
- Reception

Product Details

Ordering Code	Watt	CCT	CRI	Dimension(mm)			(cutout) D x E
				A	B	C	
HPL.Linelight-R.RE.01.14W.408.D-W	14W	4000 K	80	586	68	70	574 X 58
HPL.Linelight-R.RE.01.28W.408.D-W	28W	4000 K	80	1146	68	70	1134 X 58
HPL.Linelight-R.RE.01.36W.408.D-W	36W	4000 K	80	1146	68	70	1134 X 58
HPL.Linelight-R.RE.01.40W.408.D-W	40W	4000 K	80	1146	68	70	1134 X 58
HPL.Linelight-R.RE.01.56W.408.D-W	56W	4000 K	80	1716	68	70	1704 X 58
HPL.Linelight-R.RE.01.72W.408.D-W	72W	4000 K	80	2271	68	70	2259 X 58
HPL.Linelight-R.RE.01.80W.408.D-W	80W	4000 K	80	2271	68	70	2259 X 58

408 (40 stands for 4000K CCT to be replaced by 30 or 50 for 3000K or 5000K CCT respectively). Other CCT available on request.

408 (8 stands for 80 CRI to be replaced by 7 or 9 for 70 or 90 CRI respectively).

Replace W (white) / B (Black) Add suffix DD-Dimmable Dali, AD-Analog Dali.

60 (60 stands for 60° beam angle to be replaced by 12, 24 or 40 for 12°, 24° or 40° respectively).



Linelight-P

14W / 28W / 36W / 40W
56W / 72W / 80W

Product Description

- Pendant mounted linear down light luminaire.
- Best in class LED with high levels of efficiency and colour rendering.
- Enclosure made of heavy gauge extruded aluminium housing with powder coating finish which acts as passive heat sink.
- Extruded diffuser for higher light transmission.
- Inbuilt efficient electronic driver and electronic accessories with connectors.
- High quality suspension kit.

Product Specification

Product Type	Pendant/Surface Mounted
Lighting Source	SMD
Driver Type	Constant Current AC - DC
Input Voltage Range	180V - 270V
Power Factor	>0.95
THD	< 10%
Light Output	110lm - 160lm/W
Secondary Optics Used	High Efficiency Diffuser
Beam Angle	Diffused
Installation	Mounted on ceiling with screws for pendant high quality suspension kit.

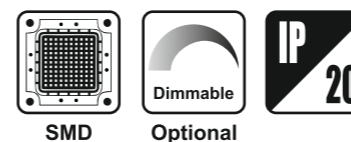
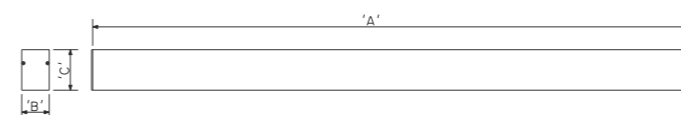

Applications

- Retail Spaces
- Ambient
- Cash Counter
- Trail Room
- Stair Cases
- Cafeteria
- Corridors
- Reception

Product Details

Ordering Code	Watt	CCT	CRI	Dimension(mm)		
				A	B	C
HPL.Linelight-P.PE.01.14W.408.D-W	14W	4000 K	80	570	70	75
HPL.Linelight-P.PE.01.28W.408.D-W	28W	4000 K	80	1130	70	75
HPL.Linelight-P.PE.01.36W.408.D-W	36W	4000 K	80	1130	70	75
HPL.Linelight-P.PE.01.40W.408.D-W	40W	4000 K	80	1130	70	75
HPL.Linelight-P.PE.01.56W.408.D-W	56W	4000 K	80	1700	70	75
HPL.Linelight-P.PE.01.72W.408.D-W	72W	4000 K	80	2255	70	75
HPL.Linelight-P.PE.01.80W.408.D-W	80W	4000 K	80	2255	70	75

408 (40 stands for 4000K CCT to be replaced by 30 or 50 for 3000K or 5000K CCT respectively). Other CCT available on request.

408 (8 stands for 80 CRI to be replaced by 7 or 9 for 70 or 90 CRI respectively).

Replace W (white) / B (Black) Add suffix DD-Dimmable Dali, AD-Analog Dali.

60 (60 stands for 60° beam angle to be replaced by 12, 24 or 40 for 12°, 24° or 40° respectively).





Rays

30W / 45W

Product Description

- Pendant mounted down light luminaire.
- Best in class LED with high levels of efficiency and colour rendering.
- Enclosure made of CRCA Die formed housing UV and corrosion resistance with durable, anti-fading and anti scratch-electrostatic.
- Fixed direct distribution only advanced thermal management to ensure long lifetime.
- Thermo painting finish with Architectural White black grey etc.
- High transmitted PC diffuser specially designed for LED light source creating smooth and uniform lighting distributions.
- Comfort for all lighting applications.

Product Specification

Product Type	Suspended/ Surface mounted
Lighting Source	SMD
Driver Type	Constant Current AC - DC
Input Voltage Range	180V - 270V
Power Factor	>0.95
THD	< 10%
Light Output	100 lm/W
Secondary Optics Used	High Efficiency Diffuser
Beam Angle	Diffused
Installation	High quality suspension kit for mounting/ Surface mounted

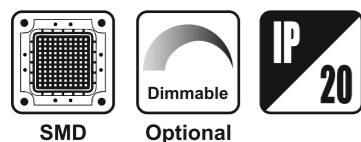
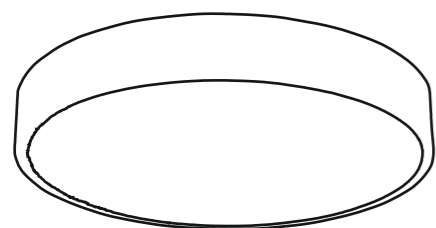

Applications

- Cash Counter
- Cafeteria
- Reception
- Window Displays

Product Details

Ordering Code	Watt	CCT	CRI	Dimension(mm)	
				ØA	B
HPLRYS40030	30W	4000 K	80	400	100
HPLRYS50045	45W	4000 K	80	500	100

408 (40 stands for 4000K CCT to be replaced by 30 or 50 for 3000K or 5000K CCT respectively). Other CCT available on request.
 408 (8 stands for 80 CRI to be replaced by 7 or 9 for 70 or 90 CRI respectively).
 Replace W (white) / B (Black) Add suffix DD-DALI Dimming, AD-Analog Dimming.
 60 (60 stands for 60° beam angle to be replaced by 12, 24 or 40 for 12°, 24° or 40° respectively).



Milan

45W

Product Description

- Pendant mounted down light luminaire.
- Enclosure made of CRCA Die formed housing UV and corrosion resistance with durable, anti-fading and anti scratch- electrostatic.
- Fixed direct distribution only advanced thermal management to ensure long lifetime.
- Thermo painting finish with Architectural White black grey etc.
- High transmitted PC diffuser specially designed for LED light source creating smooth and uniform lighting distributions.
- Comfort for all lighting applications.

Product Specification

Product Type	Suspended/ Surface mounted
Lighting Source	SMD
Driver Type	Constant Current AC-DC
Input Voltage Range	180V - 270V
Power Factor	>0.95
THD	< 10%
Light Output	100 lm/W
Secondary Optics Used	High Efficiency Diffuser
Beam Angle	Diffused
Installation	High quality suspension kit for mounting/ Surface mounted

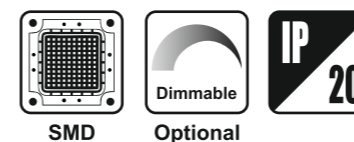
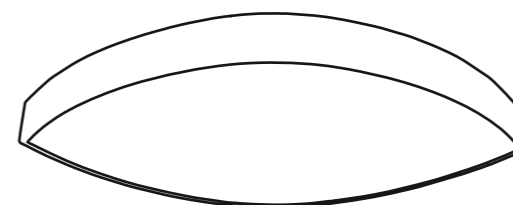

Applications

- Cash Counter
- Cafeteria
- Reception
- Window Displays

Product Details

Ordering Code	Watt	CCT	CRI	Dimension(mm)	
				ØA	B
HPLMLN45	45W	4000 K	80	CS	100

408 (40 stands for 4000K CCT to be replaced by 30 or 50 for 3000K or 5000K CCT respectively). Other CCT available on request.
 408 (8 stands for 80 CRI to be replaced by 7 or 9 for 70 or 90 CRI respectively).
 Replace W (white) / B (Black) Add suffix DD-DALI Dimming, AD-Analog Dimming.
 60 (60 stands for 60° beam angle to be replaced by 12, 24 or 40 for 12°, 24° or 40° respectively).



Trios

20W / 30W / 50W / 70W

Product Description

- Pendant mounted down light luminaire.
- Enclosure made of CRCA Die formed housing UV and corrosion resistance with durable, anti-fading and anti scratch-electrostatic.
- Fixed direct distribution only advanced thermal management to ensure long lifetime.
- Thermo painting finish with Architectural White black grey etc.
- High transmitted PC diffuser specially designed for LED light source creating smooth and uniform lighting distributions.
- Comfort for all lighting applications.

Product Specification

Product Type	Suspended/ Surface mounted
Lighting Source	SMD
Driver Type	Constant Current AC-DC
Input Voltage Range	180V - 270V
Power Factor	>0.95
THD	< 10%
Light Output	100 lm/W
Secondary Optics Used	High Efficiency Diffuser
Beam Angle	Diffused
Installation	High quality suspension kit for mounting/ Surface mounted

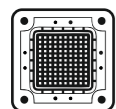
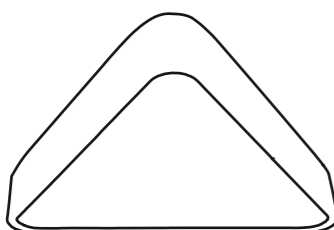

SMD



Optional



20

Applications

- Cash Counter
- Cafeteria
- Reception
- Window Displays

Product Details

Ordering Code	Watt	CCT	CRI	Dimension(mm)	
				ØA	B
HPLTR20	20W	4000 K	80	CS	100
HPLTR30	30W	4000K	80	CS	100
HPL TR50	50W	4000K	80	CS	100
HPLTR70	70W	4000 K	80	CS	100

408 (40 stands for 4000K CCT to be replaced by 30 or 50 for 3000K or 5000K CCT respectively). Other CCT available on request.
 408 (8 stands for 80 CRI to be replaced by 7 or 9 for 70 or 90 CRI respectively).
 Replace W (white) / B (Black) Add suffix DD-DALI Dimming, AD-Analog Dimming.
 60 (60 stands for 60° beam angle to be replaced by 12, 24 or 40 for 12°, 24° or 40° respectively).



Polo

30W

Product Description

- Pendant mounted down light luminaire.
- Enclosure made of CRCA Die formed housing UV and corrosion resistance with durable, anti-fading and anti scratch- electrostatic.
- Fixed direct distribution only advanced thermal management to ensure long lifetime.
- Thermo painting finish with Architectural White black grey etc.
- High transmitted PC diffuser specially designed for LED light source creating smooth and uniform lighting distributions.
- Comfort for all lighting applications.

Product Specification

Product Type	Suspended
Lighting Source	SMD
Driver Type	Constant Current AC-DC
Input Voltage Range	180V - 270V
Power Factor	>0.95
THD	< 10%
Light Output	100 lm/W
Secondary Optics Used	High Efficiency Diffuser
Beam Angle	Diffused
Installation	High quality suspension kit for mounting

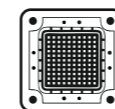
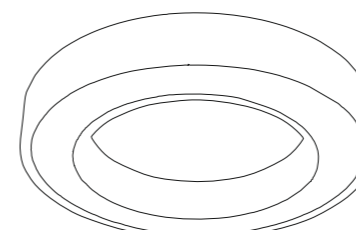

SMD



Optional



20

Applications

- Cash Counter
- Cafeteria
- Reception
- Window Displays

Product Details

Ordering Code	Watt	CCT	CRI	Dimension(mm)	
				ØA	B
POLO600P30	30W	4000 K	80	600	100

408 (40 stands for 4000K CCT to be replaced by 30 or 50 for 3000K or 5000K CCT respectively). Other CCT available on request.
 408 (8 stands for 80 CRI to be replaced by 7 or 9 for 70 or 90 CRI respectively).
 Replace W (white) / B (Black) Add suffix DD-DALI Dimming, AD-Analog Dimming.
 60 (60 stands for 60° beam angle to be replaced by 12, 24 or 40 for 12°, 24° or 40° respectively).